

Joydeem

JD-D16-GC

研磨杯 使用说明书

Grinding Cup User Manual

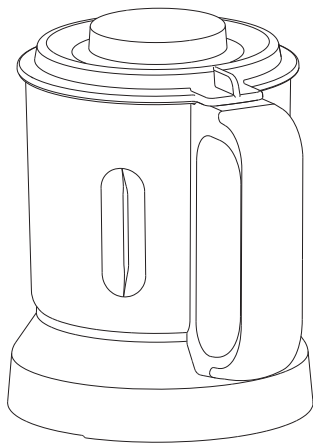

此图片仅为示意图，产品以实物为准。
使用前请仔细阅读本说明书和妥善保管，以供参考。

This product shall be subject to the real object.

Please read this manual carefully before use and keep it for reference.

产品部件名称



(上图只做示意说明与实物可能有差异，具体以实物为准。)



1. 研磨杯可搭配的机座各有差异，上图仅供参考，具体请以购买的产品为准；
2. 操作指引仅供参考。如果搭配使用的机型与之有差异，操作时有问题，可咨询导购员，或与本公司的特约维修网点或客户服务中心联系；
3. 研磨干货时，最大研磨时长请勿超过1分钟。如果研磨未能达到理想的细腻度，可以减少单次研磨的食材量，两次相邻研磨之间需停机冷却10分钟。

使用说明

使用前须知

- 1.启动机器前请放入食材，严禁空载！
- 2.研磨杯仅可用于研磨干货，严禁搅打果蔬、热食、清水等，搅打清水、果蔬、热食等可能会造成机器保护或损坏。如果机器进水造成保护，可待晾干后再使用；如果机器损坏，请咨询售后维修中心。
- 3.此研磨杯带有开盖安全保护，请注意杯盖安装到位才可启动机器。
- 4.研磨开始时噪音较大，请远离儿童使用。
- 5.研磨前请将待研磨食材脱水或烘干；研磨时请勿用手触碰不锈钢杯身，如晃动可用手扶住手柄。
- 6.最小研磨容量请勿低于100ml，最大研磨容量请勿超过500ml，豆类和水分或含油较多食材建议不超过300ml；最大研磨时长请勿超过1分钟。
- 7.机座外部可用拧干的布擦拭，请勿将机座放入水或其它液体中，也不能在水或其它液体下冲洗，以防漏电或器件损坏。
- 8.刀片较锋利，清洁时请小心刀片，以免割伤。
- 9.请勿使用钢丝球、研磨性清洁剂或腐蚀性液体（比如汽油或丙酮）来清洁产品。
- 10.机器未停稳前请勿提起研磨杯，以免损伤离合器防振垫。
- 11.研磨完成后，请小心杯身余热，注意防烫！
- 12.如果一次研磨不能达到想要的细腻度，可以再次研磨至更细腻；但请注意观察杯内食材状态，以免长时间研磨造成焦糊！
- 13.严禁搅打坚硬的中药材（如石燕、石莲子、石磁等）。

操作说明

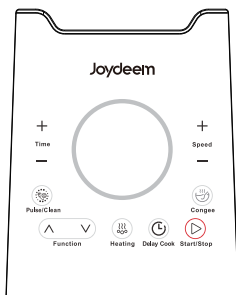

触摸按键式控制面板分为智能快捷模式和个性化操作模式，研磨时请使用个性化操作模式完成。在待机状态下，单击“时间+”功能键设置所需研磨时间，单击“速度+”功能键设置所需研磨速度；在时间、速度设置完成后，单击“启动/停止”键开始研磨，数码管显示实时档位和时间。



使用注意

1. 研磨时，请使用个性化操作模式；请勿使用果蔬、点动/清洗功能键进行研磨，带加热功能的功能键处于锁定状态无法使用。
2. 建议研磨速度为8档，低速档研磨会降低研磨效果。
3. 在使用个性化操作模式研磨过程中，单击“启动/停止”键可以暂停或回到待机状态，实际状态请以具体机型为准。
4. 只设置速度、未设置时间时，启动后机器会按当前档位运行，机器运行至程序设定时间后自动停止。该情况下默认研磨时间会超时，请使用“启动/停止”键控制最大研磨时间勿超过1分钟。

使用方法

1. 将待研磨食材放入研磨杯内，盖上杯盖并沿顺时针方向旋紧（杯盖尾部卡扣完全卡入杯柄中）。

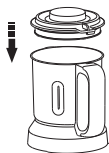

2. 将装好食材的研磨杯放置于机座上，注意检查研磨杯是否放平。

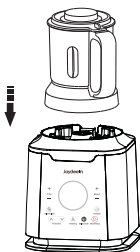

3.接通电源使用个性化操作模式进行研磨。

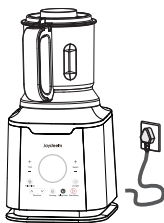

**使用
注意**

当研磨食材发现空转时，即刀片碰不到食材时，请立即停机并取下研磨杯，空转时间过长可能会导致食材焦糊！为了研磨的更细，请提前将食材脱水或烘干。

安全注意事项

特别提示

为保证使用安全，避免对您和他人造成伤害和财产损失，请您务必遵守以下安全注意事项。

不遵守安全警告而错误使用可能导致事故发生。

表示【禁止】的内容

- 本产品工作时严禁空载运行或超负载使用。
- 本产品工作时，禁止移动产品或触碰正在运动中的部件，避免意外伤害。
- 禁止在倾斜的台面或不稳定的台面使用本产品。
- 禁止加入热的食材进行搅拌（不超过80℃）。
- 禁止将产品放置在太靠近炉具的地方，以免产品受损或引起火灾和人身伤害。

表示【强制】的内容

- 在拆装或调试产品的任何部件前，请确保产品处于断电状态。
- 请勿使用本产品以外的附件和配件，以免引起火灾和人身伤害。
- 请勿在无人看管的情况下运行本产品。
- 请勿让儿童单独操作使用，确保不会将产品当成玩具，要放在婴儿接触不到的地方。老年人或残障人士以及无使用经验的人应该在监护和指导下使用本产品。

可能造成人员伤亡的事项

- 本产品工作必须确保研磨干货不超过1分钟，操作中如发现杯体或主机过热、保护，请停机约30分钟，待其冷却后方可继续操作。

可能造成轻伤或者财产损失的事项

- 使用产品后，清洗干净与食物接触的部位，避免长时不用残留物腐蚀散发出异味。
- 若产品在使用过程中出现卡死现象，请立即关掉搭配机座的电源，拔下电源插头，取下研磨杯，将卡死刀片的材料取出，待搭配机座的电机冷却后方可继续使用。
- 产品使用后，请及时拔掉搭配机座的电源及清洗产品。
- 产品使用前，请确保桌台清洁，及时清理油污。
- 本产品与其它厨房电器的最佳距离请保持30厘米以上。

Parts

Cup Lid



Grinding cup

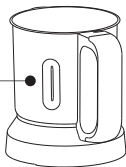

Main Body

(This product shall be subject to the real object.)



Caution

1. The machine bases that can be matched with the grinding cup are different. The above picture is for reference only. Please refer to the purchased product for details;
2. The operating instructions are for reference only. If the matched model is different from it, and there is a problem during operation, you can consult the shopping guide, or contact the company's special maintenance network or customer service center;
3. When grinding dry goods, the maximum grinding time should not exceed 1 minute. If the grinding fails to reach the desired level of fineness, the amount of food in a single grinding can be reduced, and the machine must be shut down and cooled for 10 minutes between two adjacent grindings.

Instructions before use

1. Please put in the food before starting the machine, no load is strictly prohibited!
- 2 The grinding cup can only be used to grind dry goods. It is strictly forbidden to whipped fruits and vegetables, hot food, water, etc., whipping water, fruits and vegetables, hot food, etc. may cause protection or damage to the machine. If the machine is protected by water, it can be used after drying; if the machine is damaged, please consult the after-sales service center
3. This grinding cup has safety protection for opening the lid, please pay attention to the cup lid installed in place to start the machine.
4. The noise is loud at the beginning of grinding, please keep away from children
5. Dehydrate or dry the food to be ground before grinding; do not touch the stainless steel cup body with your hands during grinding, and hold the handle with your hands if it shakes.
- 6 The minimum grinding capacity should not be less than 100ml, and the maximum grinding capacity should not exceed 500ml. It is recommended not to exceed 300ml for beans and foods with more moisture or oil; the maximum grinding time should not exceed 1 minute.
7. The outside of the base can be wiped with a wrung cloth. Do not put the base in water or other liquids, or wash it under water or other liquids to prevent leakage or damage to the components.
- 8 The blade is sharp, please be careful when cleaning the blade to avoid cuts
9. Do not use steel wool, abrasive cleaners or corrosive liquids (such as gasoline or acetone) to clean the product.
10. Please do not lift the grinding cup before the machine is stopped, so as not to damage the clutch anti-vibration pad.

11. After the grinding is completed, please be careful of the residual heat of the cup body and pay attention to prevent scalding.

12. If one grinding fails to achieve the desired fineness, you can grind again to make it more delicate; but please pay attention to the state of the ingredients in the cup to avoid to be burnt for a long time!

13. It is strictly forbidden to beat hard Chinese medicinal materials (such as stone swallow, stone lotus seed, stone magnet, etc.).

Operating Instructions

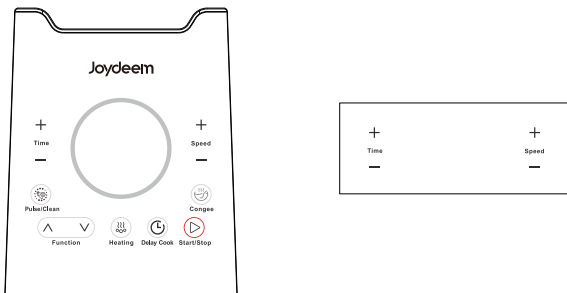

The touch button control panel is divided into smart shortcut mode and personalized operation mode. Please use the personalized operation mode to complete the grinding. In the standby state, click the "Time+ -" function key to set the required grinding time, and click the "Speed+ -" function key to set the required grinding speed; after the time and speed are set, click "Start/Stop" Button to start grinding, and the digital tube displays the real-time gear and time.



Caution

1. When grinding, please use the personalized operation mode; do not use the juice , Pause/Clean function keys for grinding, the function keys with heating function are locked and cannot be used.
 2. The recommended grinding speed is 8 gears. Low-speed grinding will reduce the grinding effect.
 3. During the grinding process using the personalized operation mode, click the "Start/Stop" button to pause or return to the standby state, the actual state depends on the specific model.
 4. When only the speed is set and the time is not set, the machine will run in the current gear after starting. The machine will stop automatically after running to the programmed time. In this case, the default grinding time will be overtime, please use the "start/stop" button to control the maximum grinding time not to exceed 1 minute.
-

Instructions

1. Put the ingredients to be ground into the grinding cup, cover the lid and tighten it clockwise (the buckle at the end of the lid is completely locked into the handle of the cup).

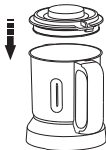

2. Place the grinding cup with the ingredients on the machine base and check whether the grinding cup is flat.

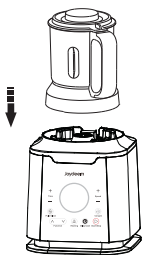

3. Turn on the power and use the personalized operation mode for grinding.

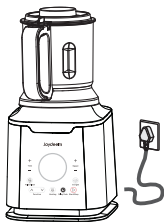

Caution

If idling, that is, when the blade cannot touch the ingredients, please stop the machine and remove the grinding cup right away. If the idle time is too long, it may cause the ingredients to be burnt! Note that in order to grind more finely, please dehydrate or dry the ingredients in advance.

Safety Instructions

Special Note

In order to ensure safe use and avoid injury and property damage to you and others, please be sure to observe the following safety instructions. Failure to observe the safety warnings and incorrect use may cause accidents.

The mark represents [prohibited] content

- No-load operation or overload use is strictly prohibited when this product is working.
- When this product is working, it is forbidden to move the product or touch the moving parts to avoid accidental injury.
- It is forbidden to use this product on an inclined or unstable table.
- It is forbidden to add hot ingredients for stirring. ($< 80\text{ C}$)
- It is forbidden to place the product too close to the stove to avoid damage to the product or cause fire and personal injury.

The mark represents [mandatory] content

- Before disassembling or debugging any part of the product, please make sure that the product is in a power-off state.
- Please do not use accessories and accessories other than this product to avoid fire and personal injury. Do not operate this product unattended.
- Do not allow children to operate and use it alone, make sure that the product is not used as a toy, and should be placed out of the reach of infants.
- Elderly or handicapped people and people without experience should use this product under supervision and guidance.

The mark represents matters that may cause casualties

- The work of this product must ensure that the grinding of dry goods does not exceed 1 minute. If the cup or the host is overheated and protected during operation, please stop it for about 30 minutes and wait for it to cool before continuing to operate.

The mark represents matters that may cause minor injuries or property damage

- After using the product, clean the parts in contact with food to avoid long-term use of residues to corrode and emit peculiar smells.
- If the product is stuck during use, please turn off the power supply of the matching frame immediately, unplug the power plug, remove the grinding cup, take out the material of the stuck blade, and wait for the motor of the matching frame to cool down before continuing to use it.
- After the product is used, please unplug the power supply that matches the base and clean the product in time.
- Before using the product, please make sure that the table is clean and clean up the grease in time.
- The best distance between this product and other kitchen appliances should be more than 30cm.

